

18 Alton Road, Luton, Bedfordshire, LU1 3NS
£360,000

- FOUR BEDROOMS
- 3 BATHROOMS
- CLOSE TO TOWN

- CHAIN FREE
- PRIVATE GARDEN
- MUST BE VIEWED

- LARGE OPEN PLAN KITCHEN DINER
- ON DRIVE PARKING
- GARAGE TO REAR

*** P&R PROPERTY SALES *** SPACIOUS 4 BEDROOMS *** LARGE OPEN PLAN KITCHEN DINER *** TWO SEPARATE RECEPTION ROOMS *** DOWNSTAIRS SHOWER ROOM *** FAMILY BATHROOM AND SEPARATE WC *** PRIVATE REAR GARDEN WITH GARAGE TO REAR *** DRIVEWAY PARKING *** CHAIN FREE *** TOWN CENTRE LOCATION *** CLOSE TO LUTON STATION & AIRPORT *** PERFECT FAMILY HOME OR BTL INVESTMENT *** GREAT HMO OPPORTUNITY *** MUST BE VIEWED ***

This property benefits from accommodation comprising of entrance hall, living room, reception room, kitchen diner, downstairs shower room, landing, three bedrooms, family bathroom, fourth bedroom, separate WC and private rear garden with garage.

ENTRANCE HALL

LIVING ROOM 12'08 X 10'08 (3.86M X 3.25M)

RECEPTION ROOM 12'10 X 10'11 (3.91M X 3.33M)

KITCHEN DINER 18'02 X 15'07 (5.54M X 4.75M)

SHOWER ROOM DOWNSTAIRS

LANDING

BEDROOM ONE 11'07 X 10'11 (3.53M X 3.33M)

BEDROOM TWO 13'00 X 9'09 (3.96M X 2.97M)

BEDROOM THREE 9'08 X 7'07 (2.95M X 2.31M)

BATHROOM

BEDROOM FOUR 12'06 X 12'00 (3.81M X 3.66M)

WC

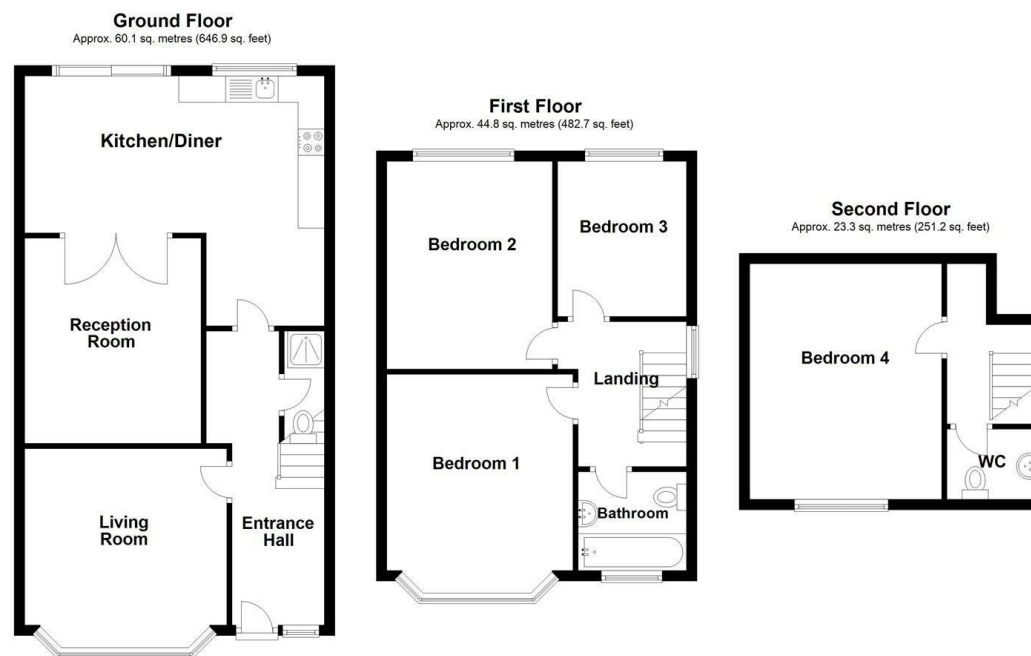

Total area: approx. 128.3 sq. metres (1380.8 sq. feet)

